



# KGP NFC Tool (IOS)

## Manual

A decorative graphic on the left side of the page consisting of several overlapping circles. One large circle is filled with a dark red color and contains the website address. Other circles are outlined in light gray and some are partially filled with a light gray color.

[www.kgp-electronics.de](http://www.kgp-electronics.de)

DEDICATED  
TO LIGHT

## Content

|   |     |
|---|-----|
| KGP NFC App Quick start guide .....                                     | 2   |
| What is the KGP NFC App .....   | 2   |
| What can the KGP NFC App be used for? .....                             | 2   |
| What is needed to use the KGP NFC App? .....                            | 3   |
| Home Screen Overview .....  | 4   |
| How to connect a Bluetooth NFC reader .....                             | 5   |
| How to read-out and program a driver .....                              | 6/7 |
| Current Selection .....   | 8   |
| Edit Configuration (available functions may depend on the driver) ..... | 9   |
| Setup a driver .....  | 10  |



## **KGP NFC App Quick start guide**

### **What is the KGP NFC App?**

The KGP NFC App provides quick and easy KGP LED driver configuration and analysis. This greatly facilitates the work of installers, maintenance technicians and employees in related fields.

### **What can the KGP NFC App be used for?**

The following features can be configured through the app if supported by the appropriate LED driver.

#### **Set the driver parameters**

- LED output current: Set the LED output current (in 1mA steps) to adjust the brightness

## **What is needed to use the KGP NFC App?**

The following prerequisites must be met in order to use the application:

- Using the KGP NFC LED driver
- The NFC scanner supports FEIG (NFC reader with Bluetooth® interface for on-site programming). In addition, the built-in NFC reader can also be used in various Apple smartphones.
- An active Internet connection for initial use and for updates. Internet connection is not really required for current work. However, for the app to work properly, the device data must always be up to date, i.e. updated regularly.

## Home Screen

### Settings:

This button opens the settings menu

### Update:

Updates the device list automatically if new devices become available.

### Internal NFC antenna:

The KGP Driver can be read-out and programmed using the internal antenna of a smartphone by pressing this button. In order to read the driver, the smartphone must be placed on it.

### Connect Bluetooth® device:

This button allows you to connect an external NFC reader (such as a FEIG reader).



To program a driver, you can either use the internal NFC antenna of your phone, if available, or connect an external NFC reader via Bluetooth®.

## How to connect Bluetooth<sup>®</sup> NFC reader

1. On the starting screen, click the Bluetooth<sup>®</sup> button
2. Press the Bluetooth<sup>®</sup> reader to connect

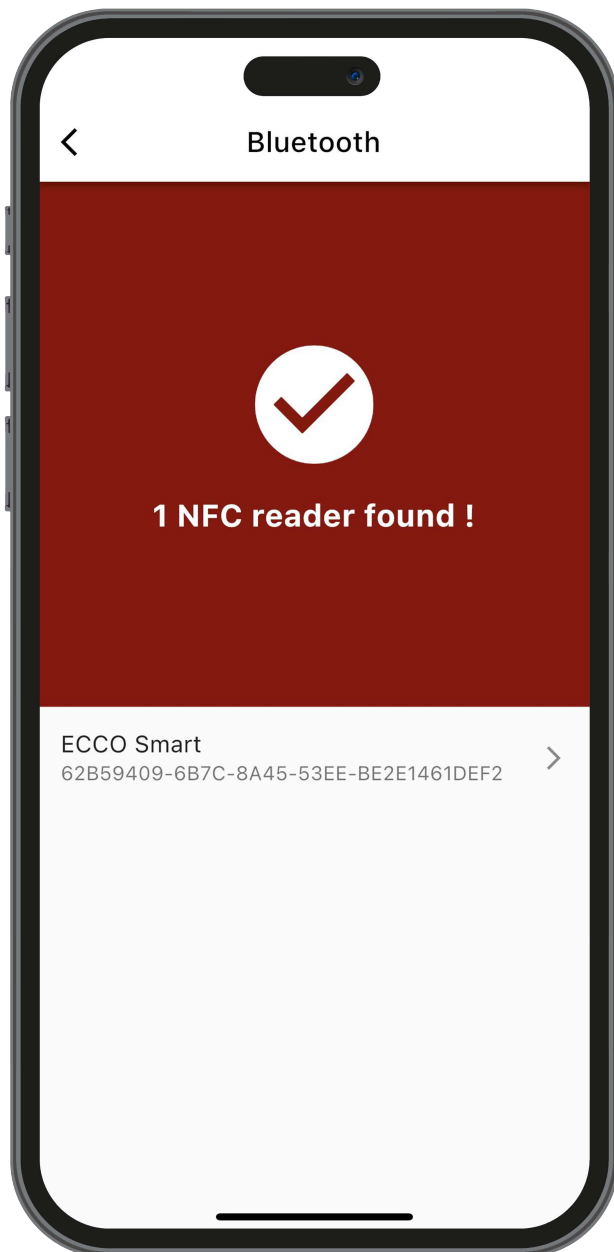

### **Connect Bluetooth<sup>®</sup> device:**

In the app, you can see all Bluetooth<sup>®</sup> NFC readers that are available.

## How to read-out and program a driver

On the starting screen, either press the internal NFC antenna button or connect an external NFC reader and press the read button. You will see the screen below.

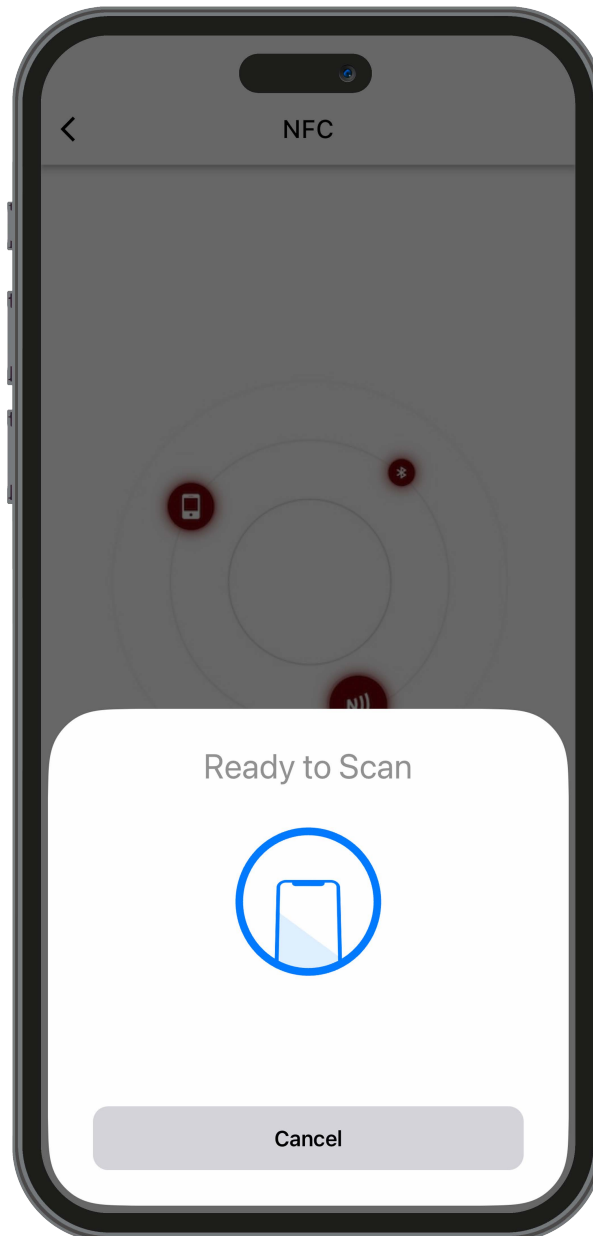

Now hold your phone or the NFC reader next to the marked area on the driver. The phone will vibrate when a connection is established. Wait for a few seconds until the driver has been read-out successfully.

After a successful read-out of the driver, a screen with some product details will appear.

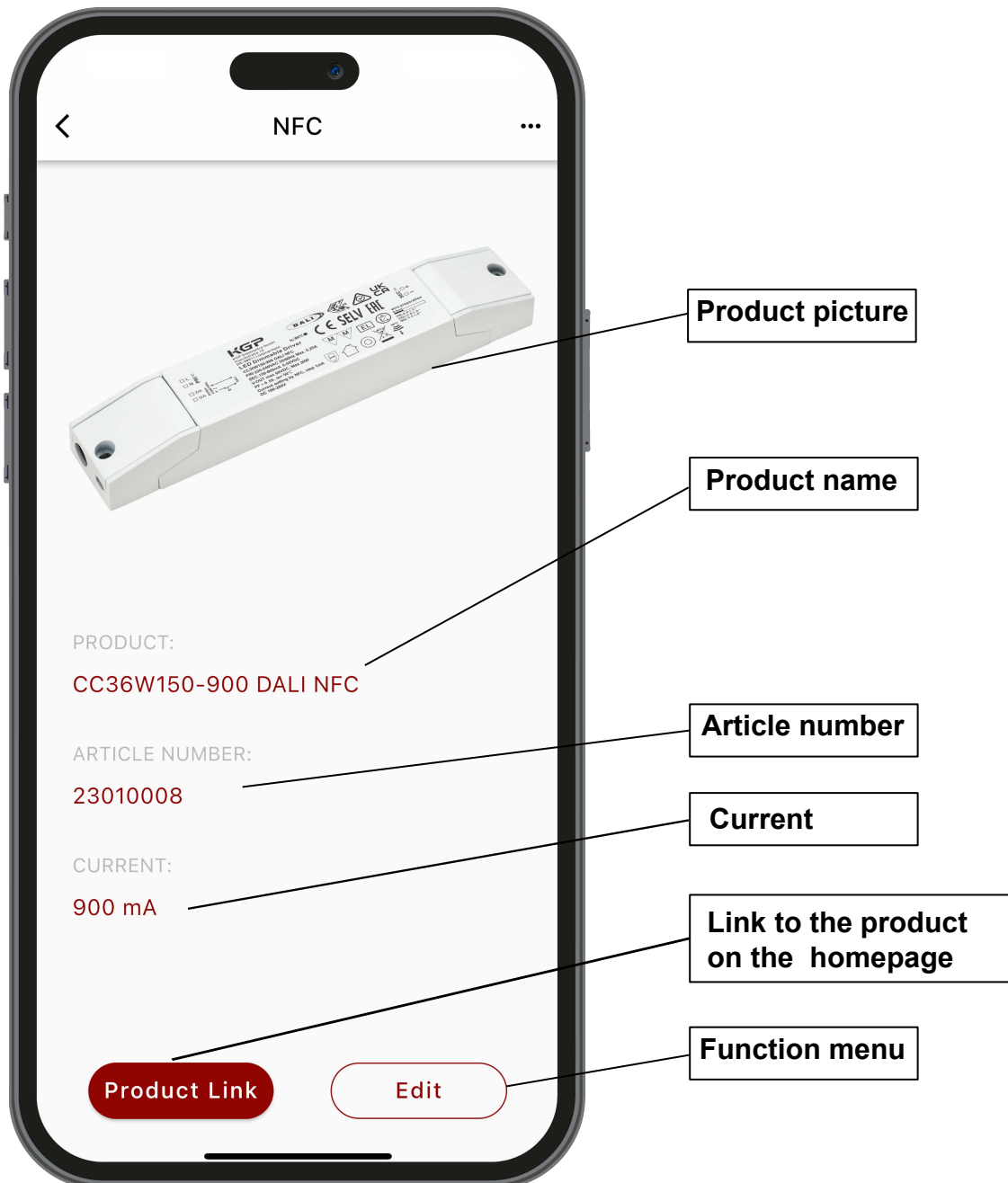



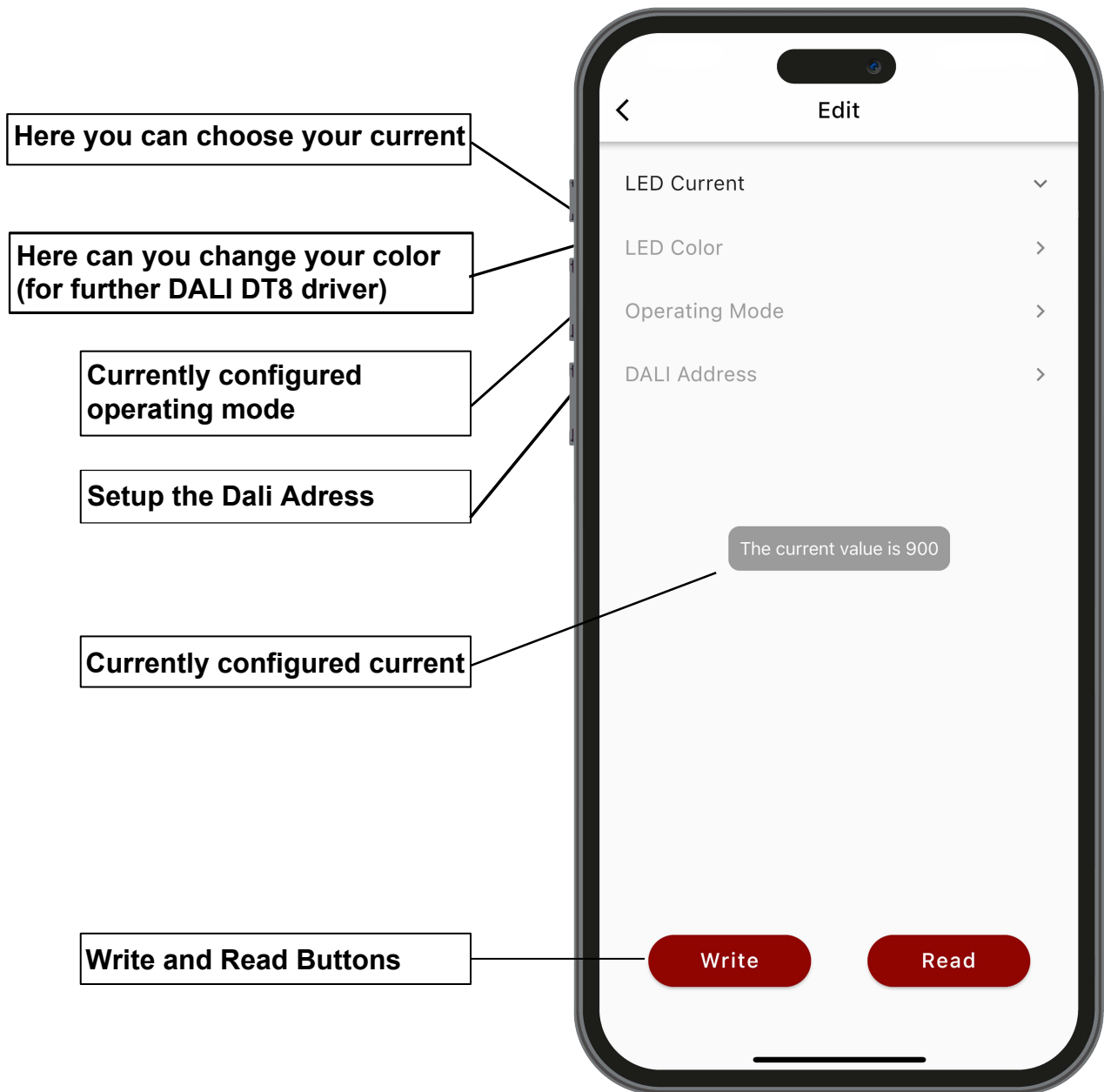

## Edit Configuration (available functions may depend on the driver)

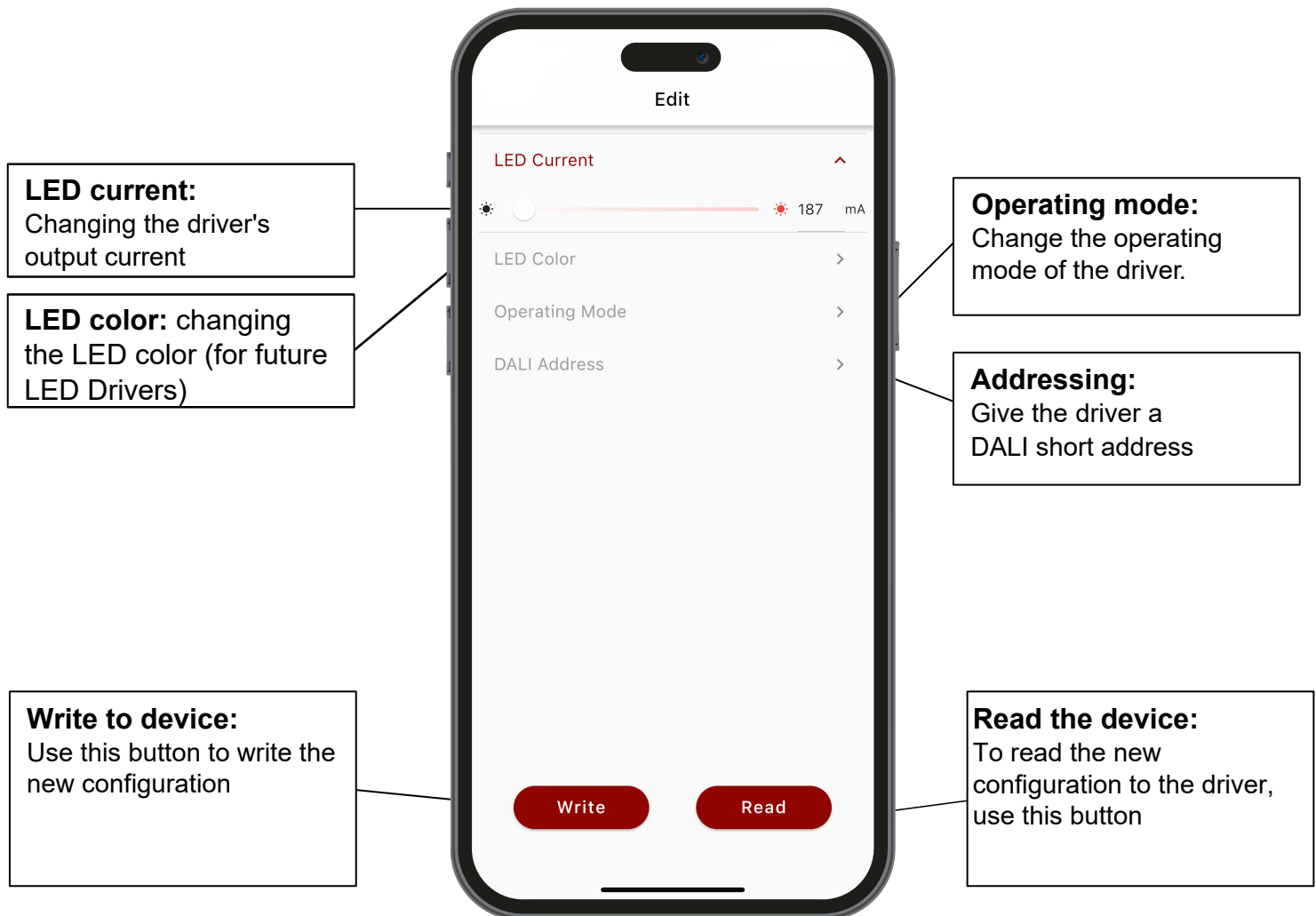

## Setup a driver

Hold your phone next to the marked NFC area of the driver and press the Write button

